

NOTES:

1. Material : Spring Steel
2. Finish : Gold Irridite - GI
3. Ends : Closed and Ground
4. Total Coils : 19.500
5. Sugg. Max. Deflection : 0.690 (in)
6. Sugg. Max. Load : 8.900 (lbs)
7. All Drawing Dimensions are in Inches [mm]

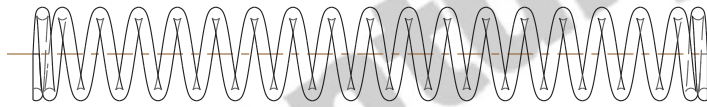

∅ 0.042
[1,07]
WIRE DIA



1.910
[48,51]
LENGTH

GROUND
SURFACE

∅ 0.312
[7,92]
O.D

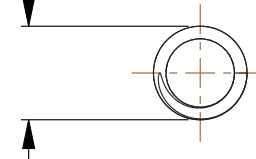

COMPONENT		SPRINGS	
Z-61 COMPRESSION SPRINGS		UNIT	INCH [mm]
		SHEET	1 of 1