

NOTES:

1. Material : Music Wire
2. Finish : Glod Irridite
3. Ends : Closed and Ground
4. Total Coils : 6.880
5. Sugg. Max. Deflection : 0.500 (in)
6. Sugg. Max. Load : 12.000 (lbs)
7. All Drawing Dimensions are in Inches [mm]

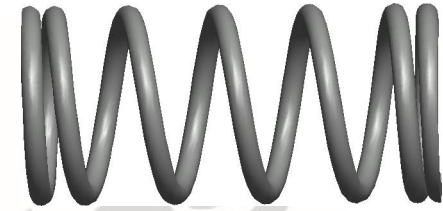

∅ 0.045
[1,14]
WIRE DIA

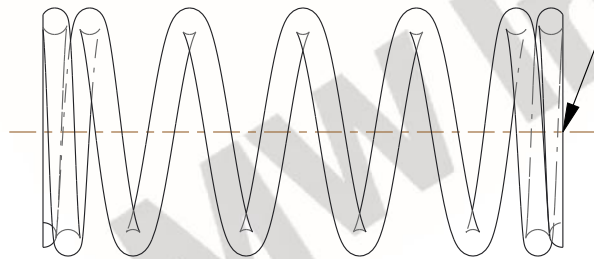

GROUND
SURFACE

1.910
[48,51]
LENGTH

∅ 0.420
[10,67]
O.D

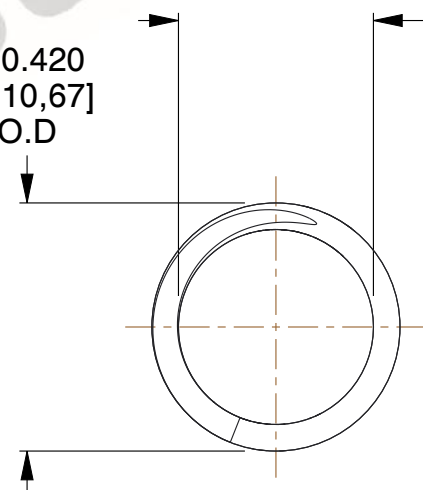

∅ 0.330
[8,38]
I.D

COMPONENT		SPRINGS	
71354		UNIT	
		INCH [mm]	
		SHEET	
COMPRESSION SPRINGS		1 of 1	