

**NOTES:**

1. Material : Music Wire
2. Finish : Glod Irridite
3. Ends : Closed and Ground
4. Total Coils : 12.100
5. Sugg. Max. Deflection : 0.790 (in)
6. Sugg. Max. Load : 6.100 (lbs)
7. All Drawing Dimensions are in Inches [mm]

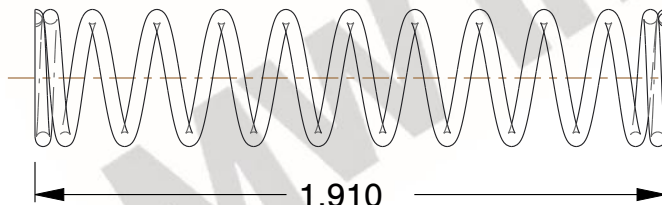

$\varnothing$  0.032  
 [0,81]  
 WIRE DIA



1.910  
 [48,51]  
 LENGTH

GROUND SURFACE

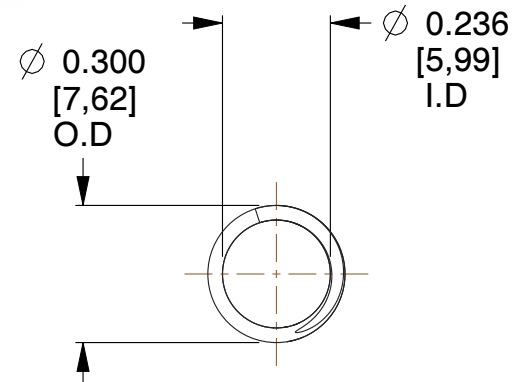

$\varnothing$  0.300  
 [7,62]  
 O.D

$\varnothing$  0.236  
 [5,99]  
 I.D

COMPONENT		SPRINGS	
<b>70862</b>  COMPRESSION SPRINGS		UNIT	INCH [mm]
		SHEET	1 of 1