

**NOTES:**

1. Material : Music Wire
2. Finish : Glod Irridite
3. Ends : Closed and Ground
4. Total Coils : 19.800
5. Sugg. Max. Deflection : 1.400 (in)
6. Sugg. Max. Load : 25.000 (lbs)
7. All Drawing Dimensions are in Inches [mm]

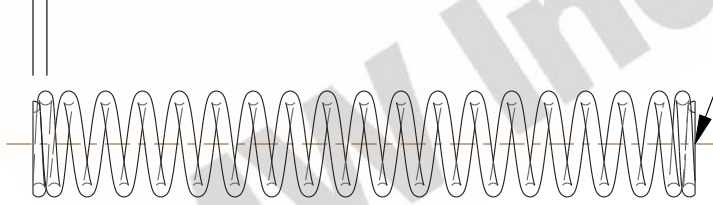

$\varnothing$  0.063  
 [1,60]  
 WIRE DIA



1.910  
 [48,51]  
 LENGTH

GROUND SURFACE

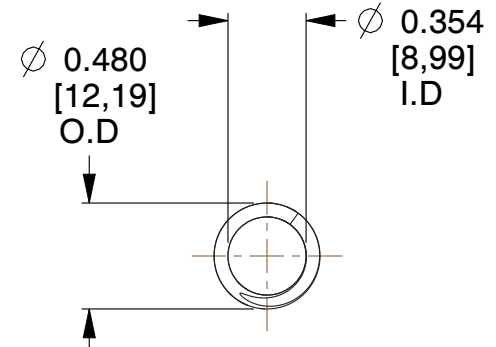

$\varnothing$  0.480  
 [12,19]  
 O.D

$\varnothing$  0.354  
 [8,99]  
 I.D

COMPONENT		SPRINGS	
<b>71574</b>  COMPRESSION SPRINGS		UNIT	INCH [mm]
		SHEET	1 of 1